

Description & Features

- Manufactured to GE® specifications
- Features a machined cast brass case with a machined cast aluminum bezel that is oil tight
- Consists of stainless steel and brass internals and stainless steel connection specific for turbine applications

Applications

- Removable bezel and lens with an adjustable micrometer pointer for in place calibration.

Specifications

Dial Size

4.5"(115mm) aluminum

Pressure Range

From 0...60 psi to 0...400 psi (0...4 bar to 0...30 bar)

Case Material

Machined cast brass, painted black

Lens Material

Glass

Pointer

Aluminum - adjustable micrometer

Bourdon Tube

316 stainless steel

Socket Material

316 stainless steel

Movement

Brass



Bezel

Machined cast aluminum bezel, painted black

Connection

1/4" in NPT, BSP, BSPT

Protection

IP 65

Working Pressure

Maximum 75% of full scale value

Over-pressure Limit

30% of full scale value

Accuracy

±0.5% ANSI/ASME Grade 2A

Options

Calibration Certificate

Order Information

Series/ Dial Size/ Case Materials/ Wetted Parts/ Configuration/ Connection Size/ Thread/ Range/ Option

Dimensions

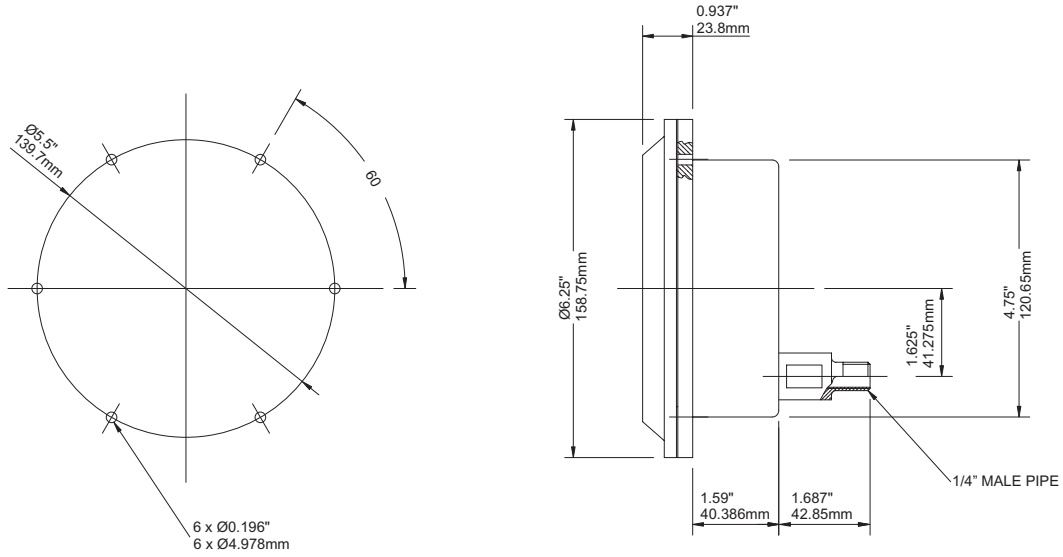

PTB Turbine Gauge

Ordering Code PTB Series

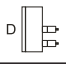
Field No.	Code	Specifications
1.	PTB	Series
2.	45	Dial Size 4.5" (115mm)
3.	B	Case Materials Brass
4.	S Z	Wetted Parts 316 SS Special
5.	D	Configuration Back connection, stem mounting
		
6.	4	Connection 1/4"
7.	N B T Z	Thread NPT BSP (G) BSPT (R) Special
8.		Range (XXXX)
		Standard Ranges
	MPa	0/0.4 0/2.5
	bar	0/4 0/25
	psi	0/60 0/400
	kg/cm²	0/4 0/25
	kPa	0/400 0/2500
9.	SO	Options Calibration Certificate