

Description & Features

- Internal diaphragm with large working volume
- Low temperature error due to large diaphragm diameter (realisation of low measuring ranges possible)
- Integrated flushing connections (optional)

Applications

- Low pressure
- Bourdon tube pressure gauges
- For aggressive, contaminated media
- Filter monitoring



Specifications

- **Mounting**
Direct or remote
- **Diaphragm Material**
AISI 316L stainless steel, welded, standard
Option: - AISI 316L stainless steel with PTFE coated
- Tantalum
- Hastelloy C
- Monel
- Other exotic material
- **Wetted Parts Material**
AISI 304 stainless steel, standard
Option: - AISI 316 stainless steel
- AISI 316L stainless steel
- AISI 316 stainless steel with PTFE coated
- Tantalum + AISI 316 stainless steel with PTFE coated
- Hastelloy C + AISI 316 stainless steel with PTFE coated
- Monel + AISI 316 stainless steel with PTFE coated
- Other exotic material
- **Minimum operating pressure range**
-1...0 bar
- **Maximum operating pressure range**
0...60 bar
- **Process connection**
G1/2" B, 1/2" NPT, M20X1.5
- **Filled Fluid**
Silicone Filled (Limited temperature range: -40/160°C)
High temperature oil (High limited temperature range: -30/230°C)
Food compatible fluid (Limited temperature range: -20/160°C)
Fluorolube Filled (Limited temperature range: -50/150°C)

Dimensions (Unit: mm)

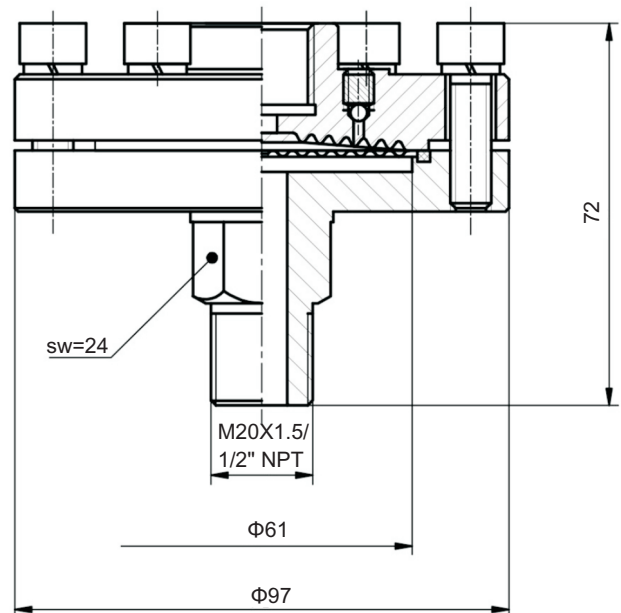

Ordering Code D37 Series

Field No.	Code	Specifications
1.	D37	Series
		Process Connection Size
2.	2	1/2"
	3	3/8"
	Z	Special request
		Process Connection Thread
3.	N	NPT
	G	G B
	T	BSPT
	P	BSPP
	M	M20X1.5
	Z	Special request
		Diaphragm Materials
4.	L	AISI 316L stainless steel
	P	AISI 316L stainless steel with PTFE coated (-1 bar to 40 bar with PTFE coating -20°C to 150°C with PTFE coating)
	H	Hastelloy C
	A	Tantalum
	M	Monel
	Z	Special request
		Wetted Parts Materials
5.	T	AISI 304 stainless steel
	S	AISI 316 stainless steel
	L	AISI 316L stainless steel
	P	AISI 316 stainless steel with PTFE coated (-1 bar to 40 bar with PTFE coating -20°C to 150°C with PTFE coating)
	H	Hastelloy C + AISI 316 stainless steel with PTFE coated
	A	Tantalum + AISI 316 stainless steel with PTFE coated
	M	Monel + AISI 316 stainless steel with PTFE coated
	Z	Special request
		Assembly
6.	D	Direct assembly
	1	1m 304 stainless steel remote capillary
	6	1.5m 304 stainless steel remote capillary
	2	2m 304 stainless steel remote capillary
	3	3m 304 stainless steel remote capillary
	4	4m 304 stainless steel remote capillary
	5	5m 304 stainless steel remote capillary
	8	8m 304 stainless steel remote capillary
	Z	Special request
		Filled Fluid
7.	B	Silicone Filled (Limited temperature range: -40/160°C)
	F	High temperature oil (High limited temperature range: -30/230°C)
	G	Food compatible fluid (Limited temperature range: -20/160°C)
	E	Fluorolube Filled (Limited temperature range: -50/150°C)